

Quick Installation Guide

USB2.0 or FireWire/USB2.0 Enclosures (HEXD3UB/HEXD3U2)

Aluminum Enclosures for *3.5" Hard Disk Drive * For any capacity 3.5" ATA Hard Drives

For more information, please refer to the user manual in the CD.

Note: The diagrams below are using the (HEXD3UB/HEXD3U2) as an example

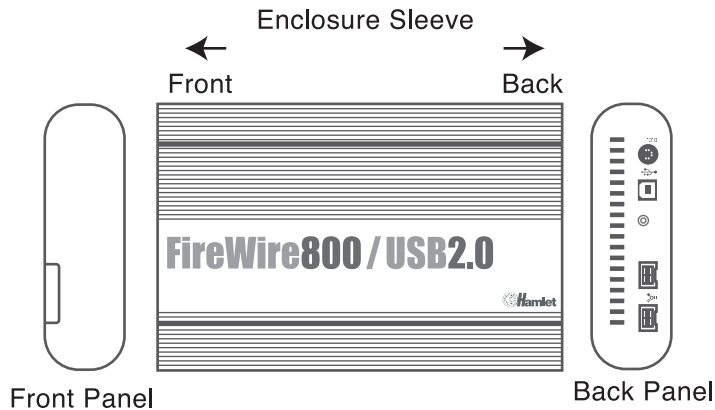

1. Unscrew to loosen the Back Panel and remove the Back Panel from the Enclosure.



2. Use your thumb to push the Base Plate out.



3. Set the Enclosure Sleeve aside.



4. Install 4 white Anti-Shock Mounts w/screw into both sides of the hard drive. Do not tighten the screws yet.



5. Connect **A** the 40-pin connector and **B** the power connector from the Base Plate securely to the hard drive.

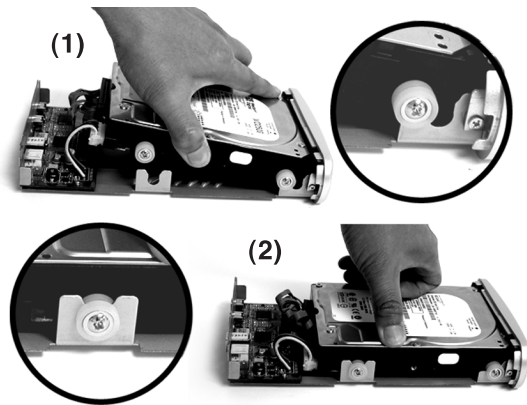

6. (1) Slide the hard drive into the Base Plate and (2) press down on the hard drive, make sure all 4 Anit-Shock Mounts sit inside the Support Slot.

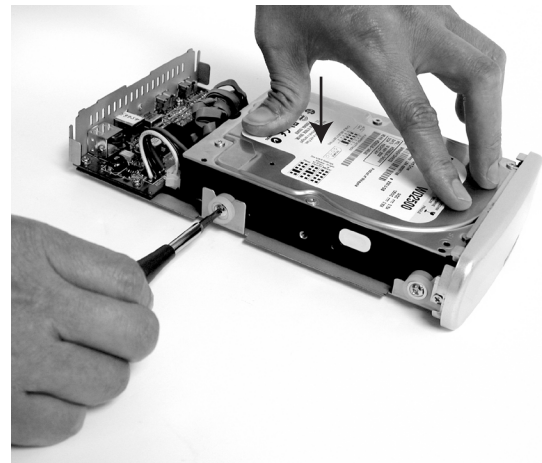

7. Pressing down the hard drive and tighten all 4 screws to secure the hard drive to the Base Plate.

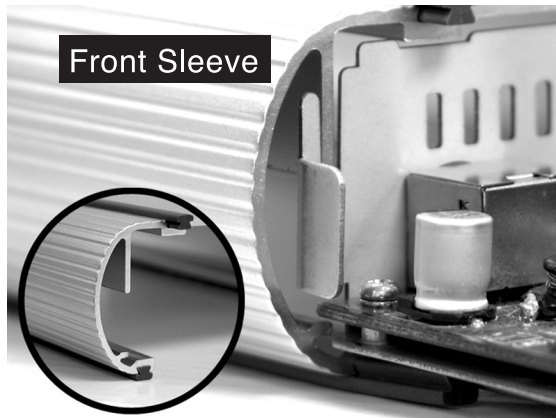

8. Align the Base Plate to the Sleeve Slot. Slide and push the hard drive/Base Plate into the Enclosure Sleeve

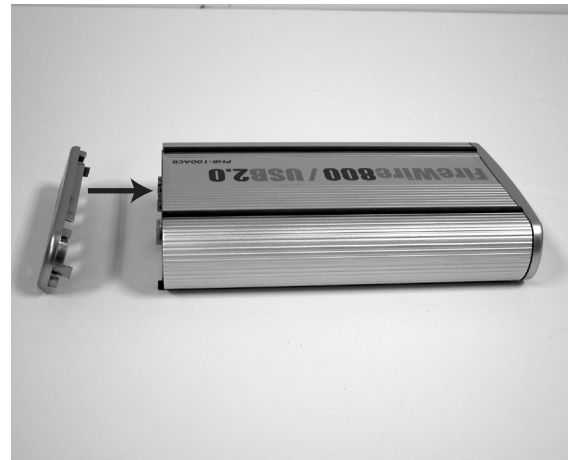
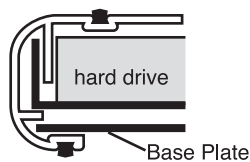

9. Install the Back Panel to the Enclosure.



10. Secure the Back Panel with the screw



11. Plug the AC adapter into the Enclosure. You may now connect the unit to your computer using a USB or FireWire Cable.