

Quick Installation Guide For CD-ROM/RW/DVD-ROM/DVD Combo Drives

USB2.0 or FireWire/USB2.0 Enclosures (HEXD5U2/HEXD5UA)

For more information, please refer to the user manual in the CD.

Parts needed for assembly: Enclosure, Two 5mm screws, Four 7mm screws, a Philips screw driver

Note: The diagrams below are using the (HEXD5U2/HEXD5UA) as an example

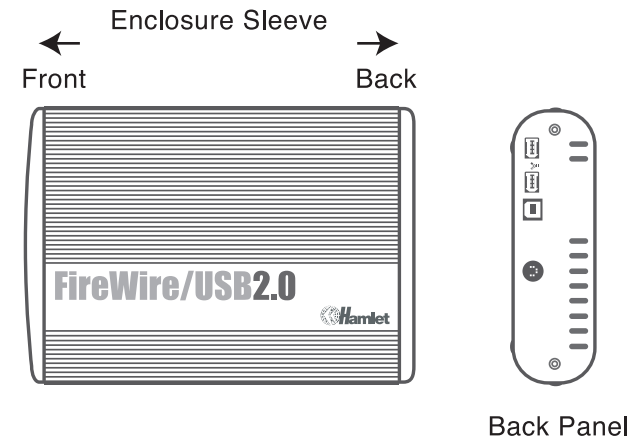

2. Remove the Back Panel from the Enclosure.

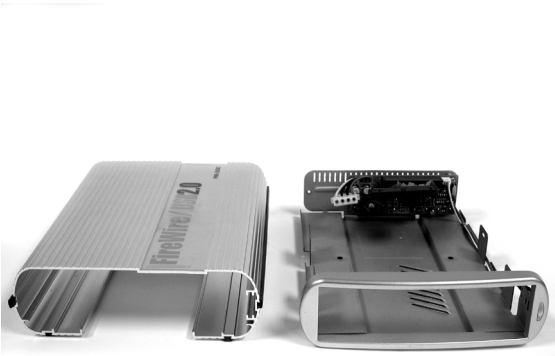

4. Set the Enclosure Sleeve aside.



1. Unscrew two 5mm diameter screws to loosen the Back Panel.



3. Use your thumb to push the Base Plate out.

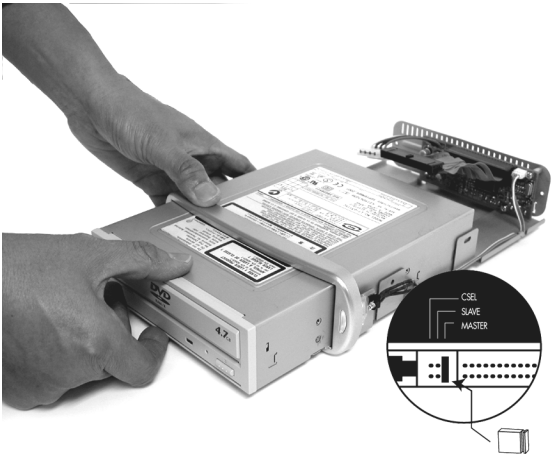

5. Set up the jumper ID as “Master” mode according to the Drive jumper setting spec .Slide the Drive into the Base Plate.

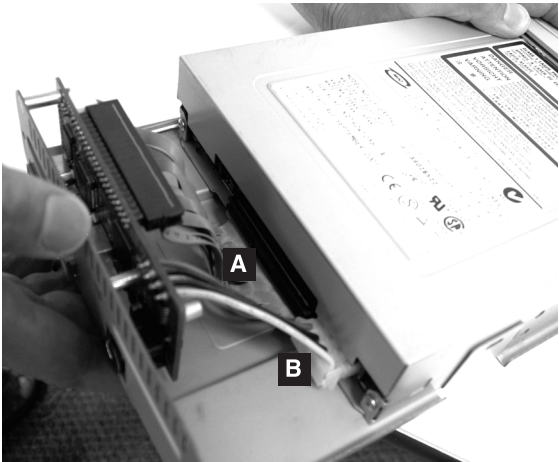

6. Connect **A** the 40-pin IDE connector and **B** the power connector from the Base Plate securely to the Drive.



8. Secure the Drive to the Base Plate with four 7mm diameter screws on both side.



10. Install the Back Panel to the Enclosure and secure the Back Panel with two 5mm diameter screws.



7. Push the Drive all the way into the Base Plate.

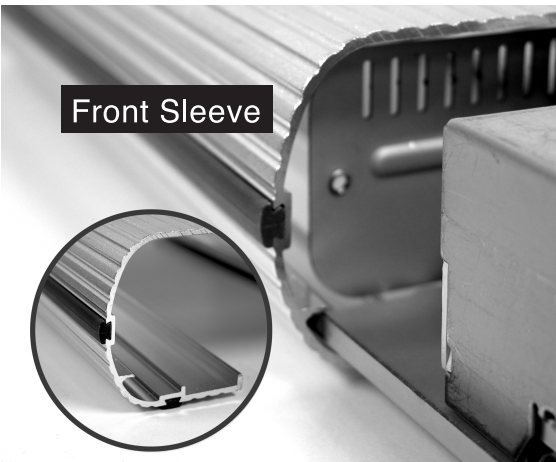

9. Align the rear Base Plate to the Sleeve Slot. Slide and push the Drive/Base Plate into the Enclosure Sleeve

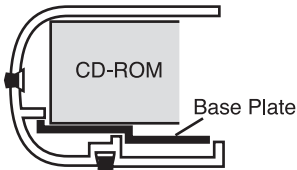

11. Plug the AC adapter into the Enclosure. You may now connect the unit to your computer using a USB or FireWire Cable.